

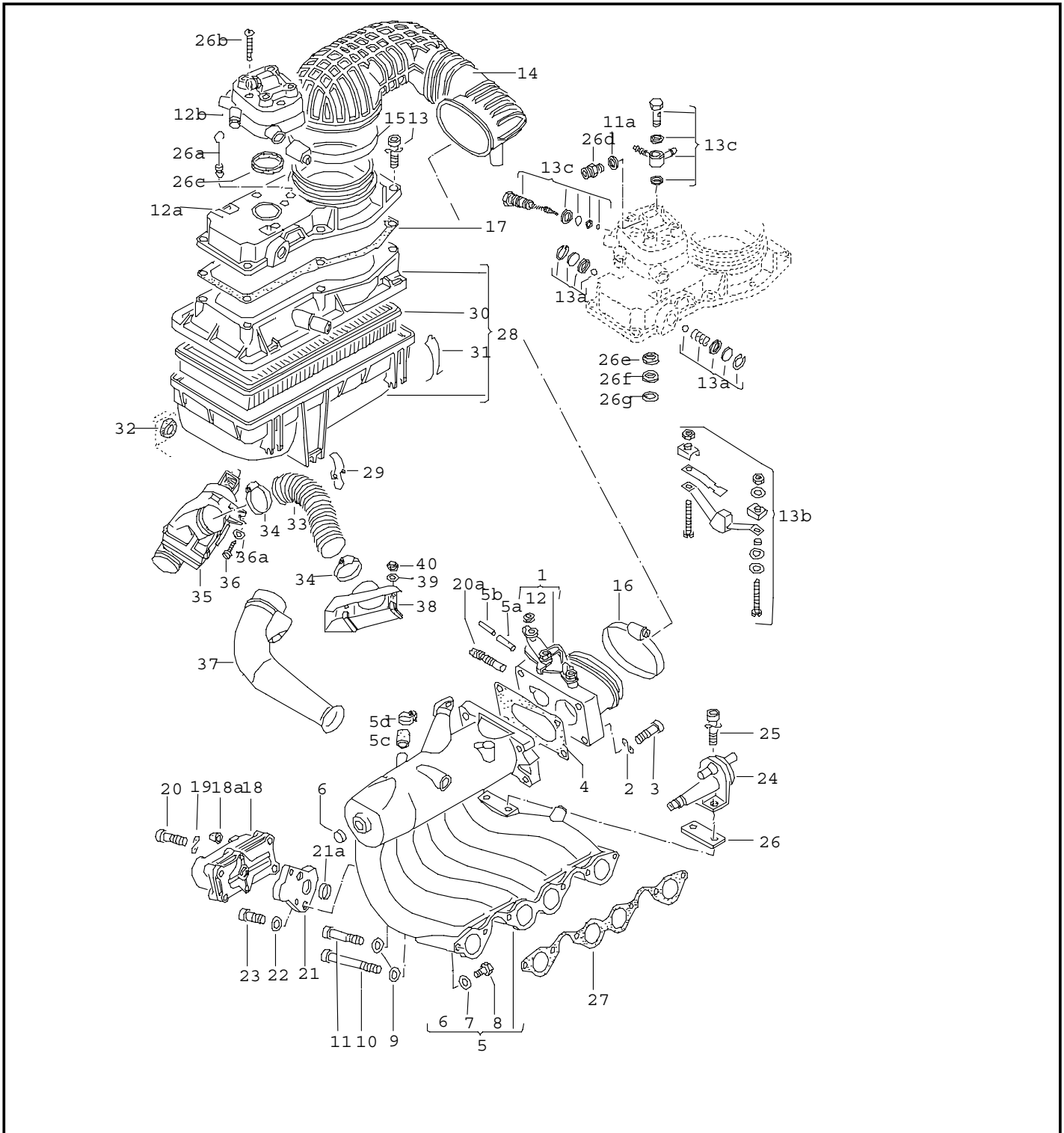

ETKA



Model	Year	MG:	SG:	Illustration	Restrictions	Update		
DA	77	1	33	30-00		569	10:12	04.07.2009





ETKA



Model DA	Year 77	MG: 1	SG: 33	Illustration 30-00	Restrictions	Update 569	10:12	04.07.2009
-------------	------------	----------	-----------	-----------------------	--------------	---------------	-------	------------

Pos	Part Number	Name	Remarks	Qty	Model
		intermediate wheel intake manifold air cleaner with connecting parts			
2	N 012 241 10	spring washer	B8X15X0,8	4	
3	N 014 717 2	bolt, with hex. socket hd.	M8X40	4	
4	049 133 073 B	gasket		1	
5	--- --- ---	no longer available		1	YH
5A	N 020 353 5	hose in coils of 5m 'order qty. 5'	3,5X2	X	
		shorten to:	26MM		
5B	N 043 205 1	dowel pin	4H8X24	X	
5C	049 133 335	cap	10MM	X	
5D	N 905 618 01	clamp	AL16-28	X	
6	--- --- ---	no longer available			
7	--- --- ---	no longer available sealing washer	C12X16		
8	N 016 024 1	plug	M10X1	1	
9	N 011 558 11	washer	8,4X15X1,6	6	
10	N 044 714 1	bolt, with hex. socket hd.	M8X80	2	
11	N 014 751 3	bolt, with hex. socket hd.	M8X50	4	
11A	N 013 807 6	sealing washer	A8X11,5	1	
12	055 129 346	bushing for pin		2	
12A	--- --- ---	no longer available		1	
(12B)	049 133 481 M	fuel metering valve F 327 2000 001>>		1	
(13)	N 014 703 5	bolt, with hex. socket hd.	M6X18	6	
		also use:	N 014 703 5	6	
-	N 012 226 5	spring washer	B6X12X0,5	6	



E T K A



Model DA	Year 77	MG: 1	SG: 33	Illustration 30-00	Restrictions	Update 569	10:12	04.07.2009
-------------	------------	----------	-----------	-----------------------	--------------	---------------	-------	------------

Pos	Part Number	Name	Remarks	Qty	Model
13A	063 133 417	control lever mounting		1	
13B	063 133 419	stop		1	
13C	035 198 685	parts kit for fuel metering valve		1	
-	035 198 691	set of gaskets for fuel metering valve		1	
14	049 133 357 A	intake air duct		1	
15	N 024 521 2	clamp	AL120-140	1	
16	N 024 518 3	clamp	AL70-90	1	
17	049 133 379 A	gasket		1	
18	063 133 403	warm-up valve		1	
(18)	063 133 403 A	warm-up valve with barometric unit for altitudes above 1220 m/3688 ft F 327 2000 001>>		1	
18A	063 133 415	protective cap with barometric unit for altitudes above 1220 m/3688 ft F 327 2000 001>>		1	
19	N 012 226 5	spring washer	B6X12X0,5	2	
20	N 014 743 2	bolt, with hex. socket hd.	M6X30	2	
20A	049 133 432	adjusting screw		1	
21	049 133 435	intermediate plate		1	
21A	049 127 311	gasket	26,5X2,5	1	
22	N 012 241 10	spring washer	B8X15X0,8	2	
23	N 014 770 2	bolt, with hex. socket hd.	M8X15	2	
24	049 133 453	idle air control		1	
(25)	N 014 703 5	bolt, with hex. socket hd.	M6X18	2	
		also use:	N 012 226 5	2	
-	N 012 226 5	spring washer	B6X12X0,5	2	



ETKA



Model DA	Year 77	MG: 1	SG: 33	Illustration 30-00	Restrictions	Update 569	10:12	04.07.2009
-------------	------------	----------	-----------	-----------------------	--------------	---------------	-------	------------

Pos	Part Number	Name	Remarks	Qty	Model
26	--- --- ---	no longer available		1	
26A	--- --- ---	no longer available			
26B	049 133 483	fillister hd. screw		3	
26C	049 133 485 A	sealing washer F >> 326 2300 000	25,5X2	1	
(26C)	034 133 476	round seal F 327 2000 001>>	29,5X1,5	1	
26D	063 133 541	adapter	8X1/12X1,5	1	
26E	063 133 487	sealing washer		1	
26F	063 133 489	adjusting washer	0,1	1	
26G	063 133 489 A	adjusting washer	0,5	1	
27	026 129 717 D	gasket		1	
(28)	--- --- ---	no longer available			
-	067 133 847	plug	7,5	1	
29	867 129 797	retaining clip		1	
30	049 133 843	filter element		1	
(31)	068 129 797	retaining clip		4	
32	055 129 669	rubber mounting	17/11,8	2	
33	049 129 627 T	air hose	40,2X550	1	
34	N 024 507 7	clamp	AL32-50	2	
35	* 049 133 871 B	control box		1	
36	* N 013 971 3	tapping screw, fill. hd.	B4,8X22	1	
36A	* N 011 665 3	washer	5,3X15X1,6	1	
37-38	--- --- ---	no longer available			
39	N 011 558 11	washer	8,4X15X1,6	2	
40	175 129 650	hex. nut, self-locking	M8	2	
- - - E N D - - -					



ETKA



Model	Year	MG:	SG:	Illustration	Restrictions	Update		
DA	77	1	33	31-00		569	10:13	04.07.2009

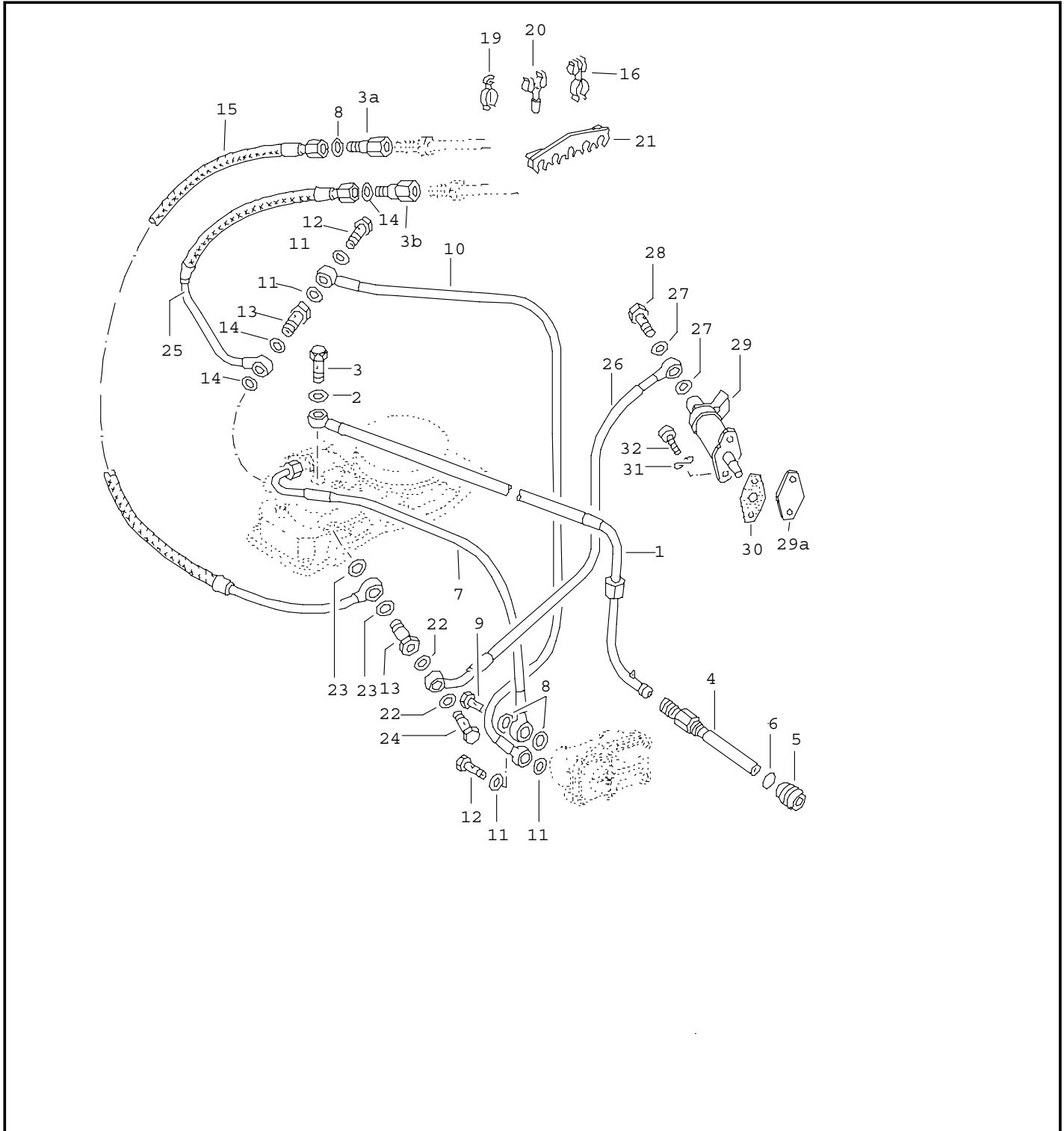



ETKA



Model DA	Year 77	MG: 1	SG: 33	Illustration 31-00	Restrictions	Update 569	10:13	04.07.2009
-------------	------------	----------	-----------	-----------------------	--------------	---------------	-------	------------

Pos	Part Number	Name	Remarks	Qty	Model
		cold start valve, injector with fuel pipes			
(1)	049 133 317 C	fuel line	cylinder 2	1	
(1)	049 133 319 C	fuel line	cylinder 3	1	
2	N 013 807 6	sealing washer	A8X11,5	4	
3	N 901 836 03	banjo bolt	LL3-5	4	
3A	--- --- ---	no longer available	feed	1	
3B	035 133 530	check valve F 327 2000 001>>	return	1	
4	049 133 551 A	injector		4	
5	063 133 555	insert for injector		4	
6	034 133 557 E	round seal	6X5,2	4	
7	--- --- ---	no longer available			
8	N 013 807 6	sealing washer	A8X11,5	X	
9	N 901 836 03	banjo bolt	LL3-5	1	
(10)	--- --- ---	no longer available			
12	N 901 836 03	banjo bolt	LL3-5	2	
13	049 133 245	banjo bolt		2	
14	N 013 812 8	sealing washer	A12X15,5X1,5	2	
15	--- --- ---	no longer available			
-	N 013 812 8	sealing washer	A12X15,5X1,5	2	
-	048 133 505	banjo bolt with filter	M12X1,5	1	
(16)	443 957 818 C	tie wrap	7X273-8	1	
(19)	443 957 818 C	tie wrap	7X273-8	1	
20	049 133 687 B	bracket		1	
21	035 133 689	bracket	8 point	2	
22	N 013 807 6	sealing washer	A8X11,5	X	
23	N 013 812 8	sealing washer	A12X15,5X1,5	2	



ETKA



Model	Year	MG:	SG:	Illustration	Restrictions	Update	10:13	04.07.2009
DA	77	1	33	31-00		569		

Pos	Part Number	Name	Remarks	Qty	Model
(25)	--- --- ---	no longer available			
26	--- --- ---	no longer available			
(26)	049 133 715 D	fuel line F 327 2000 001>>		1	
27	N 013 807 6	sealing washer	A8X11,5	2	
28	N 901 836 03	banjo bolt	LL3-5	1	
29	063 906 171	cold start valve		1	
30	050 906 179	gasket		1	
31	N 012 226 5	spring washer	B6X12X0,5	2	
32	N 014 702 10	bolt, with hex. socket hd.	M6X15	2	
		- - - E N D - - -			